

DATI TECNICI / TECHNICAL DATA / TECHNISCHE DATEN
 CARACTÉRISTIQUES TECHNIQUES / DATOS TÉCNICOS / CARACTERÍSTICAS TÉCNICAS

CV RCV	i	n ₁ = 2800 min ⁻¹			n ₁ = 1400 min ⁻¹			n ₁ = 900 min ⁻¹					
		n ₂ min ⁻¹	Mn ₂ Nm	P ₁ kW	n ₂ min ⁻¹	Mn ₂ Nm	P ₁ kW	n ₂ min ⁻¹	Mn ₂ Nm	P ₁ kW	IEC B5	IEC B14	NEMA
191 241	1.26	2222	17	4.0	1111	20	2.4	714	20	1.5	63-71-80-90-100-112	90-100-112	56-140
	2.23	1256	25	3.4	628	30	2.0	404	30	1.3	63-71-80-90-100-112	90-100-112	56-140
	2.73	1026	26	2.9	513	31	1.7	330	31	1.1	63-71-80-90-100-112	90-100-112	56-140
	3.22	870	27	2.5	435	32	1.5	280	32	0.96	63-71-80-90	90	56-140
	4.11	681	34	2.5	341	41	1.5	219	41	0.96	63-71-80-90	90	56-140
	4.71	594	37	2.4	297	44	1.4	191	44	0.90	63-71-80-90	90	56-140
	5.47	512	36	2.0	256	44	1.2	165	44	0.77	63-71-80-90	90	56-140
	7.82	358	39	1.5	179	47	0.90	115	47	0.58	63-71-80-90	90	56-140

DIMENSIONI / DIMENSIONS / ABMESSUNGEN / DIMENSIONS / DIMENSIONES / DIMENSÕES

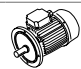
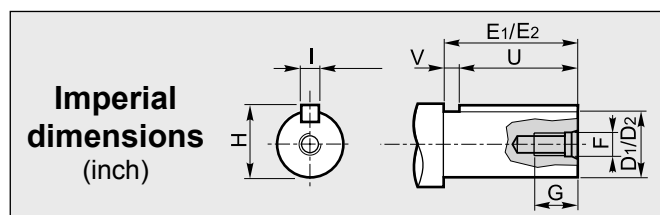
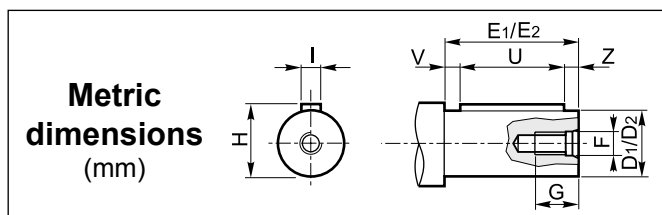

1 **Albero entrata / Input shaft / Antriebswelle**
Arbre d'entrée / Eje de entrada / Eixo de entrada

D ₁	E ₁	F	G	H	I	U	V	Z
19	40	M6	15	21.5	6	30	5	5

2 **Albero uscita / Output shaft / Abtriebswelle**
Arbre de sortie / Eje de salida / Eixo de saída

CV-RCV 191

D ₂	E ₂	F	G	H	I	U	V	Z
14	30	M5	12	16	5	20	5	5
19	40	M6	16	21.5	6	30	5	5
20	40	M8	18	22.5	6	30	5	5
24	50	M8	18	27	8	40	5	5
25	40	M8	18	28	8	30	5	5

2 **Albero uscita / Output shaft / Abtriebswelle**
Arbre de sortie / Eje de salida / Eixo de saída

D ₂	E	F	G	H	I	U	V
19.05 ⁽¹⁾ (0.750)	40 (1.575)	5/16-18	18 (0.709)	21.14 (0.832)	4.76 (0.188)	25.4 (1.000)	14.6 (0.575)

(Inch)

2 **Albero uscita / Output shaft / Abtriebswelle**
Arbre de sortie / Eje de salida / Eixo de saída

CV-RCV 241

D ₂	E ₂	F	G	H	I	U	V	Z
14	30	M5	12	16	5	20	5	5
19	40	M6	16	21.5	6	30	5	5
20	40	M8	18	22.5	6	30	5	5
24	50	M8	18	27	8	40	5	5
25	40	M8	18	28	8	30	5	5

2 **Albero uscita / Output shaft / Abtriebswelle**
Arbre de sortie / Eje de salida / Eixo de saída

D ₂	E	F	G	H	I	U	V
25.40 ⁽²⁾ (1.000)	50 (1.969)	5/16-18	18 (0.709)	28.17 (1.109)	6.35 (0.250)	38.10 (1.500)	11.9 (0.469)

(Inch)

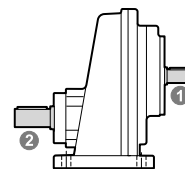

A richiesta / On request / Auf Anfrage / Sur demande / Bajo demanda / Sob consulta



P

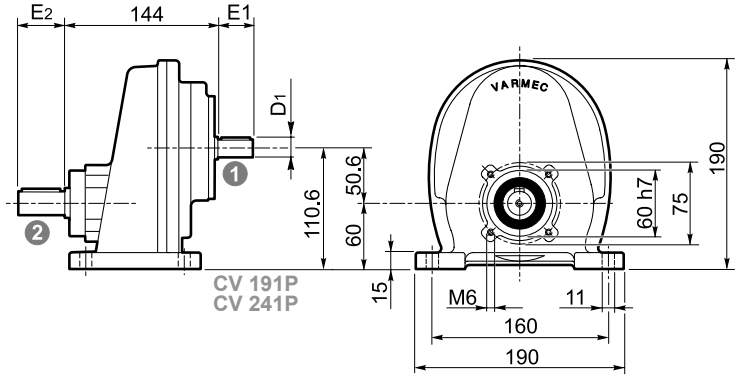
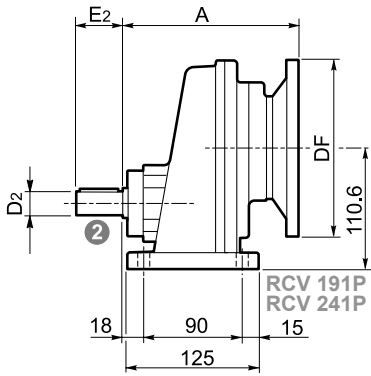

N

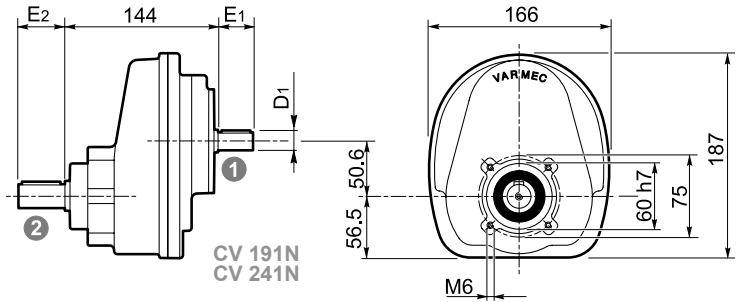
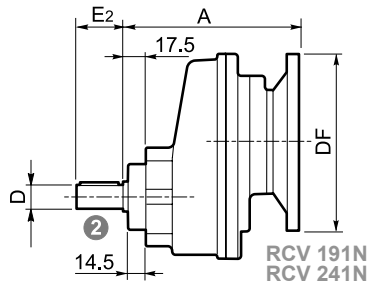

NF..

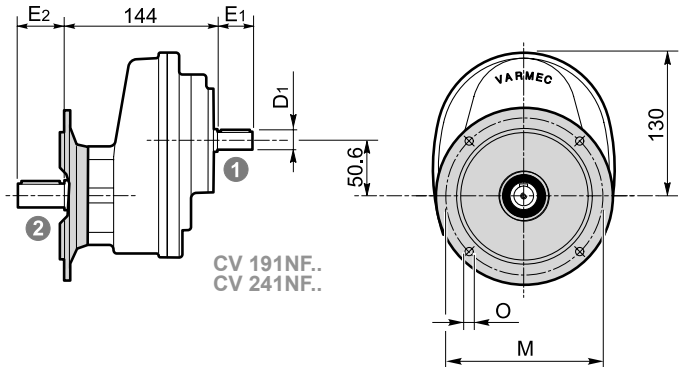
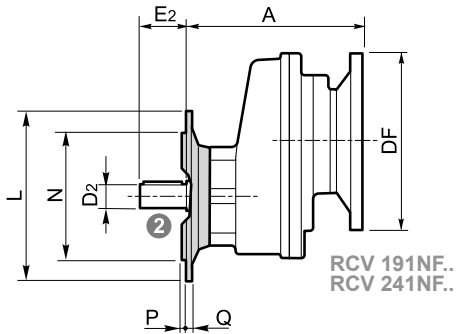

PF..

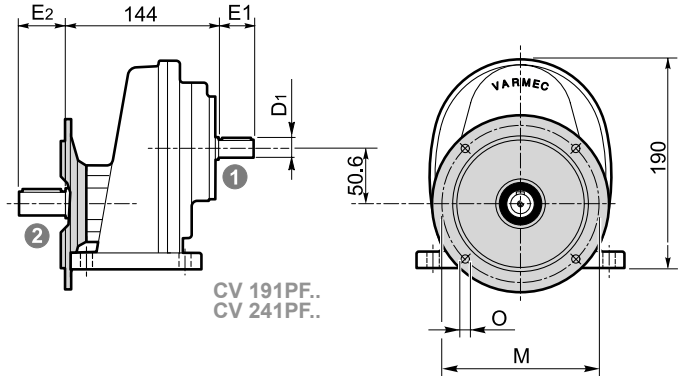
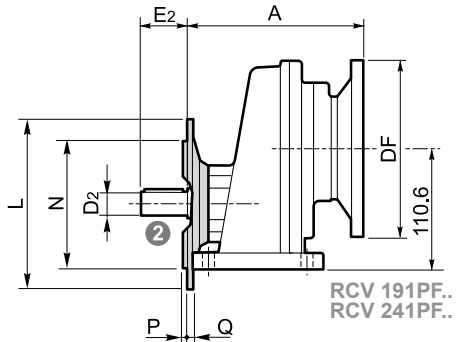

IEC	DF		A	NEMA	DF	A
	(B5)	(B14)				
63	140		150	56	165.1	158
71	160			140	165.1	158
80	200					
90	200	140	167.5			
100	250	160				
112	250	160				

	L	M	N	O	P	Q
NF120 - PF120	120	100	80	7	2.5	10
NF140 - PF140	140	115	95	9	3	10
NF160	160	130	110	11	3	10
NF200	200	165	130	11	3	10